



Murray Edwards
College
University of Cambridge



The Cambridge
Meeting Space



Fellows' Suite

Also known as Fellows' Drawing and Dining Rooms (FDR)

Perfect for intimate meetings, this all-inclusive space can be set up in a variety of styles to suit your meeting, with catering served in the adjoining Drawing Room. These two rooms can be set up with portable A.V. equipment if required. Direct access to the Fellows' Garden offers the opportunity for a breath of fresh air or a post-even BBQ or drinks reception.

Room Dimensions

Drawing Room
14m x 8m (112m²)

Dining Room
13.5m x 6m (81m²)

A.V. equipment
Portable projector, screen and audio can be provide.

Theatre style **60**

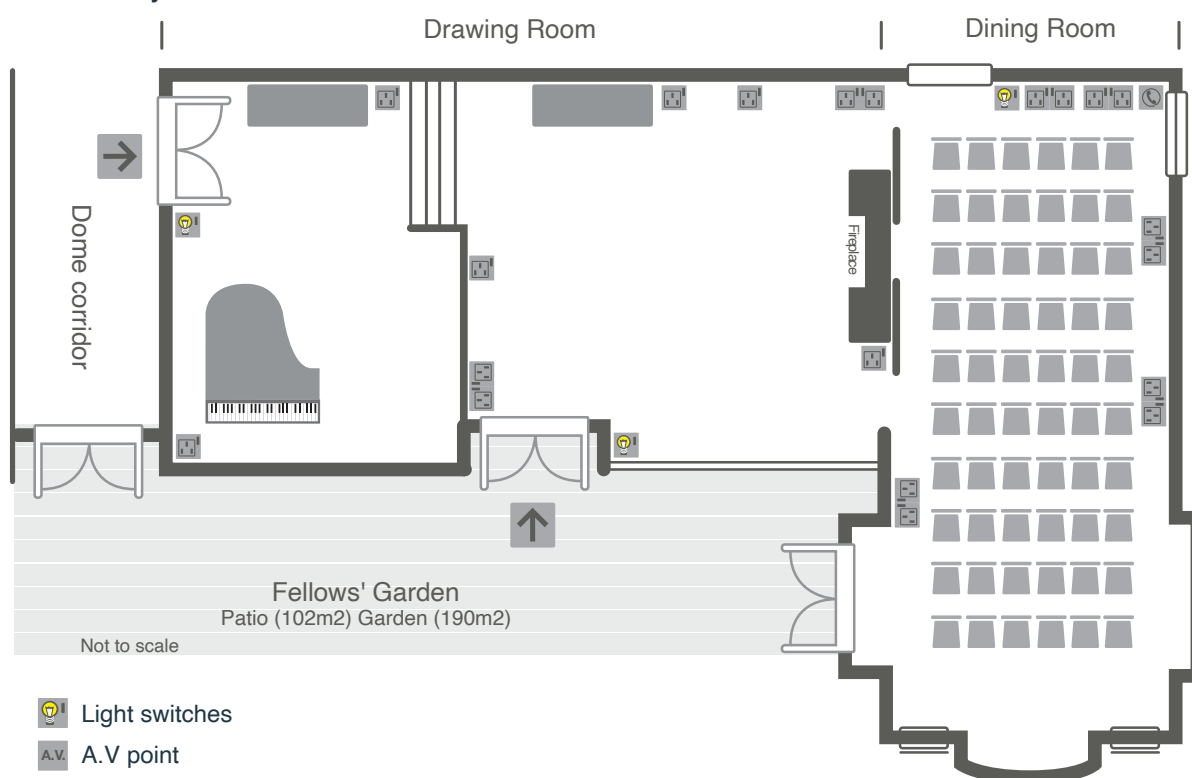

- Light switches
- A.V. point
- Double plug socket
- Single plug socket
- Entrance door

See reverse for additional layout options



Murray Edwards
College
University of Cambridge

Alternative room layouts

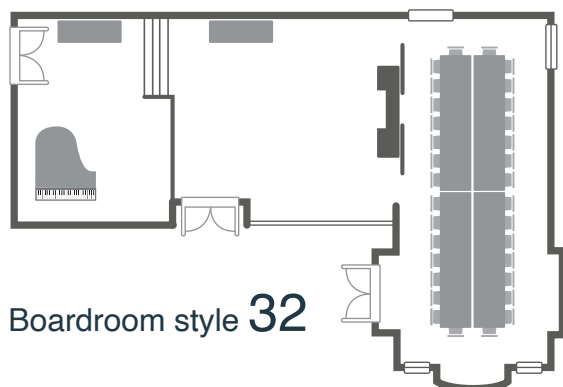

Boardroom style **32**

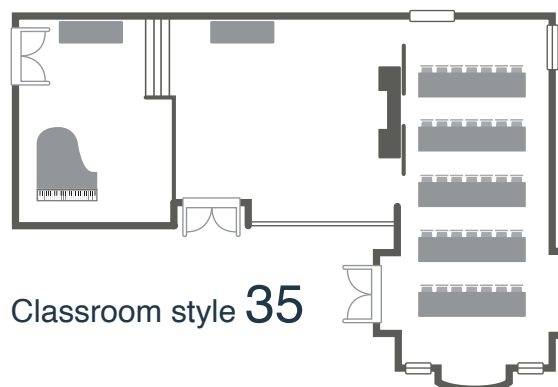

Classroom style **35**

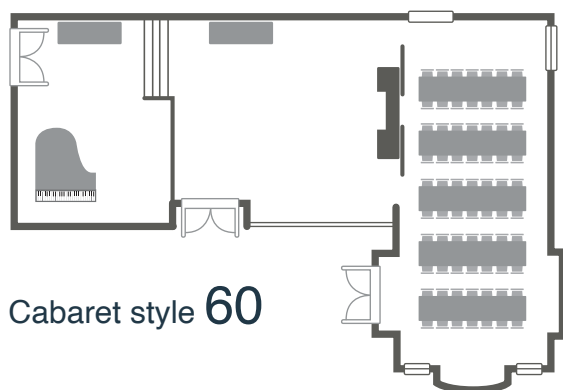

Cabaret style **60**

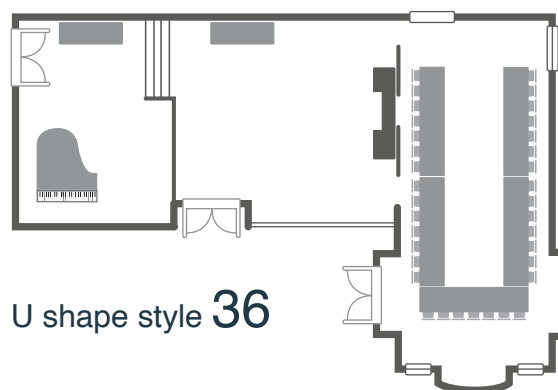

U shape style **36**

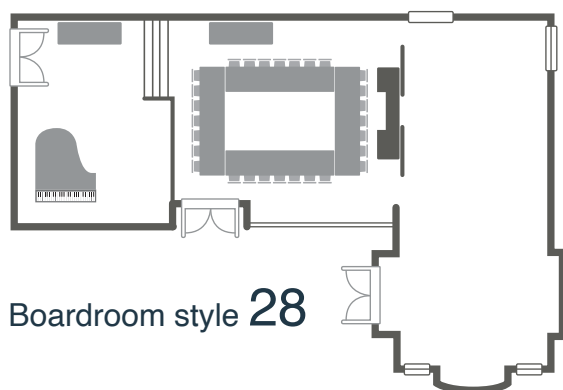

Boardroom style **28**

Please contact us for more information
on booking these rooms

events@murrayedwards.cam.ac.uk
www.murrayedwardsevents.com

Parking

70 parking spaces are available at our car park accessed via Storeys' Way. Spaces are on a first-come, first-served basis.

Location

The Fellows' Suite is located past the entrance to the Dome on the ground floor.

A detailed College map is available on our website, or from the Porters' Lodge.

Fire Assembly Point

In the unlikely event of a fire, please note the Fire Assembly Point is on the front entrance, near the Porters' Lodge.

Other information

This room is fully accessible.