

**Buckingham  
House**



**The Cambridge  
Meeting Space**



## Lecture Theatre

This raked theatre seats 140 delegates integrated AV. A comfortable and well-presented room for presentations and lectures; there is a low stage with lectern and space for panels or top tables.

AV can be controlled via the lectern, from the rear of the room and by a technician from our AV office. There is space at the rear of the lecture theatre for translation booths and we can provide equipment for voting or additional screens for Social Media feeds – our technician would be delighted to discuss your ideas.

Theatre style **140**

**Room Dimensions**  
13m x 11m (143m<sup>2</sup>)

6 spaces designated for  
wheelchair users

### A.V. equipment

HD projector  
Fixed screen  
Audio;  
stereo ceiling speakers  
mics 2 x radio, 2 x lapel,  
3 x table top mics on lecterns  
Sound and HD visual recording  
Wi-Fi is available  
A second lectern is available

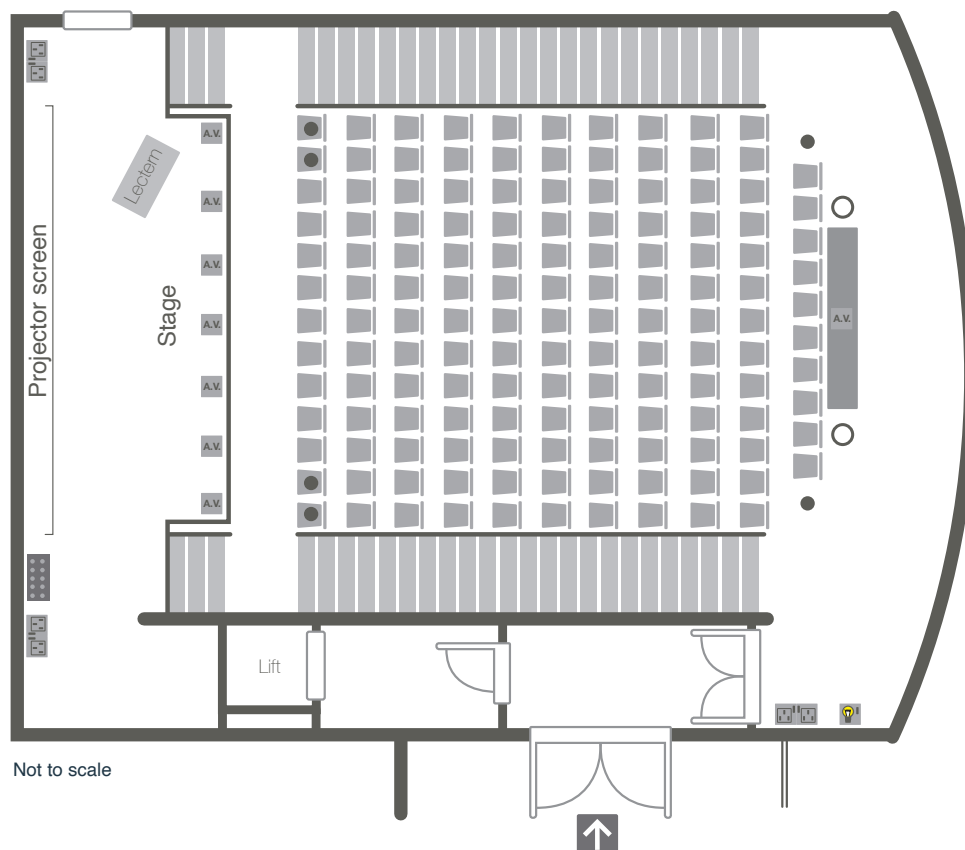

- Light switches
- A.V. point
- Double plug socket
- Single plug socket
- Entrance door
- Designated for wheelchair users
- Lectern control box
- Pillars



**Murray Edwards  
College**  
University of Cambridge

## Rooms also available in Buckingham House



### Seminar Rooms 1&2

This versatile room can be divided into 2 soundproof meeting rooms and set up in a variety of styles. This room has direct access to the deck and foyer and plenty of natural daylight, alongside black-out blinds. Seating 36 people cabaret style, this room is a great space for allowing ideas to flow in workshops.



### Syndicate Rooms 3&4

Located on levels one and two of Buckingham House, accessible by stairs or lift, these bright, intimate meeting rooms are suitable for up to 22 delegates and can be set up with the standard A.V. equipment, if required. Available in vacations only.

Please contact us for more information on booking these rooms

**events@murrayedwards.cam.ac.uk**  
**www.murrayedwardsevents.com**

### Parking

70 parking spaces are available at our car park accessed via Storeys' Way. Spaces are on a first-come, first-served basis.

### Location

The Lecture Theatre is located on the ground floor of Buckingham House.

A detailed College map is available on our website, or from the Porters' Lodge.

### Fire Assembly Point

In the unlikely event of a fire, please note the Fire Assembly Point is on the front entrance, near the Porters' Lodge.

### Other information

This room is fully accessible with access to front and rear of seating and the stage.